

Date: December 2024 **Author:** Brittany Ponych 604-861-7187 **Project:** 31399647
Comments:

FORTIS BC

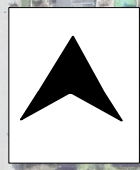

City of Chilliwack
Address: 9525 Coote St
Scope of Work: Fortis BC gas service install
Closure Description: MOTI Figure 7.8
This plan is based on a 50 km/h roadway speed
All specifications are based on the MOTI manual 2020 edition

NOTES:

- SPEED LIMIT ON COOTE STREET IS 50KM PER HOUR
ALL SIGNS WILL BE PLACED ON TRIPOD STANDS
- SPEED LIMIT ON ALL SIDE STREET IS 50KM PER HOUR
ALL SIGNS WILL BE PLACED ON TRIPOD STANDS
- ALL SIDEWALKS WILL REMAIN OPEN
- ALL CROSSWALKS WILL REMAIN OPEN
- TRAFFIC CONTROL WILL ASSIST WITH DRIVEWAYS AFFECTED
BY WORK ZONE CLOSURE
- LETTERS TO RESIDENTS/BUSINESSES TO BE HAND DELIVERED 72 HOURS
PRIOR TO CONSTRUCTION
- TRAFFIC CONTROL TO COMPLY WITH SECTION 18 OF WORK SAFE BC
REGULATIONS
- ROAD WILL BE RESTORED OUTSIDE WORKING HOURS
- 3.2M TRAVEL LANE WIDTH WILL BE MAINTAINED AT ALL TIMES
- NO PARKING SIGNS WILL BE INSTALLED 72 HOURS PRIOR TO WORK

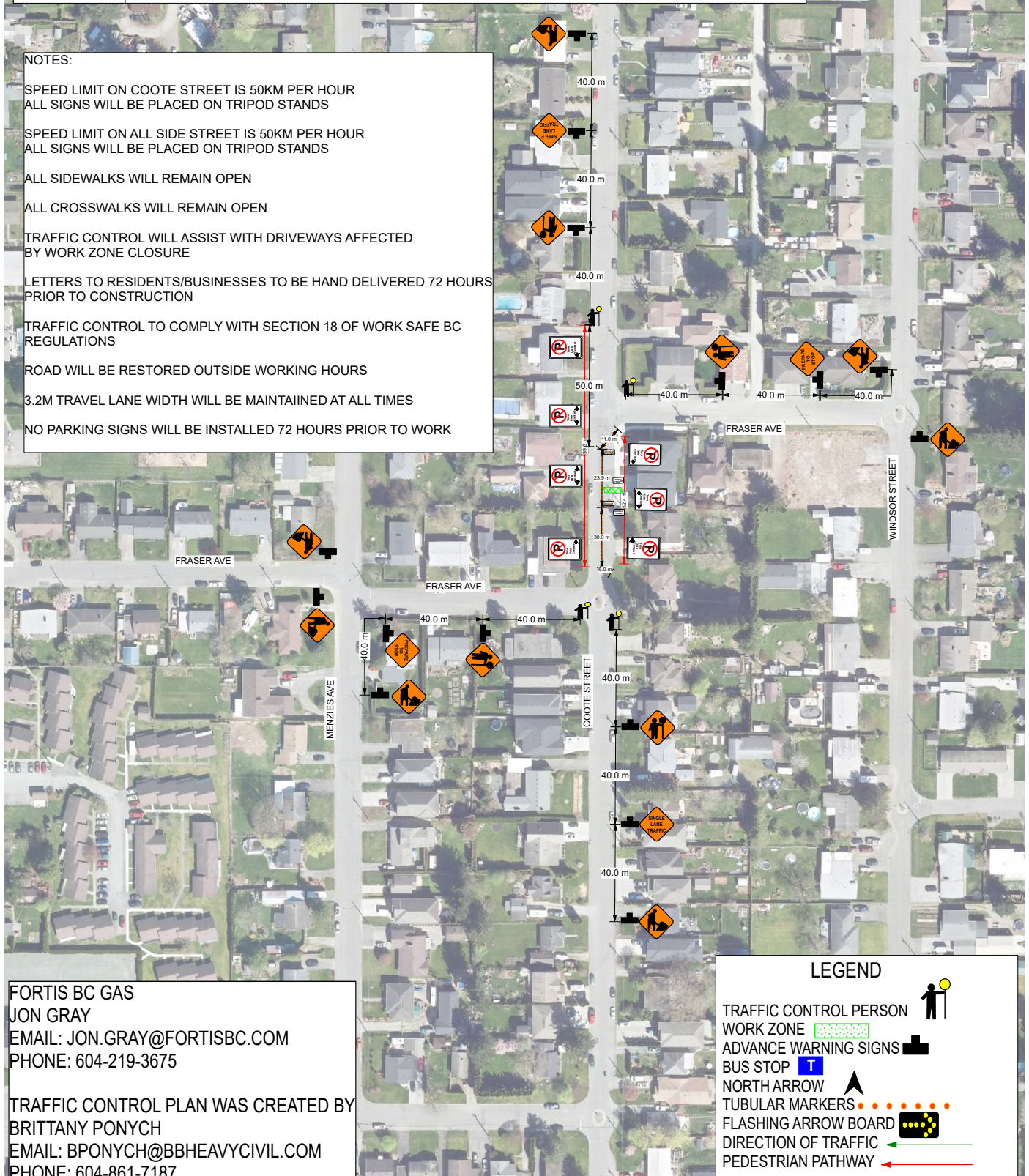

FORTIS BC GAS
 JON GRAY
 EMAIL: JON.GRAY@FORTISBC.COM
 PHONE: 604-219-3675

TRAFFIC CONTROL PLAN WAS CREATED BY
 BRITTANY PONYCH
 EMAIL: BPONYCH@BBHEAVYCIVIL.COM
 PHONE: 604-861-7187

LEGEND

- TRAFFIC CONTROL PERSON
- WORK ZONE
- ADVANCE WARNING SIGNS
- BUS STOP
- NORTH ARROW
- TUBULAR MARKERS
- FLASHING ARROW BOARD
- DIRECTION OF TRAFFIC
- PEDESTRIAN PATHWAY